

## CPVC Pipe & Threaded Fittings

### CPVC Fittings

#### Reducing Coupling



|                            |  |
|----------------------------|--|
| Sizes                      | DN25 x DN20 (1" x 3/4")                            |
| Approvals                  | UL, C-UL Listed & FM, MEA, NSF, & LPCB Approved    |
| Rated Pressure             | 12,1 bar (175 psi)                                 |
| Maximum Temperature Rating | 65°C (150°F).                                      |
| Tech Data Sheet            | <b>TFP1915 and Installation Handbook - IH-1900</b> |

Manufactured with Lubrizol's BLAZEMASTER® compound ■ Produced from BlazeMaster® thermoplastic compound, RAPID RESPONSE CPVC fittings are designed exclusively for use in wet and dry pipe automatic fire sprinkler systems. ■ Our CPVC is easier to install than traditional steel components, while providing superior heat resistance and strength compared to traditional CPVC and PVC fitting materials.

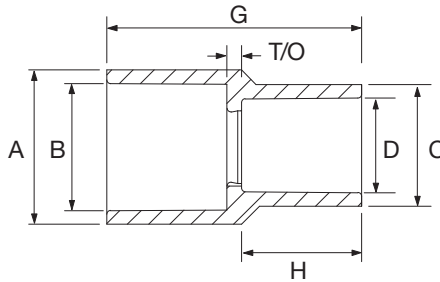

| CPVC Reducing Coupling |    |     |    |      |         |         |         |                        |                        |              |                   |    |    |     |     |
|------------------------|----|-----|----|------|---------|---------|---------|------------------------|------------------------|--------------|-------------------|----|----|-----|-----|
| Part No.               | B  |     | D  |      | A<br>mm | C<br>mm | H<br>mm | T/O <sup>1</sup><br>mm | T/O <sup>2</sup><br>mm | Weight<br>kg | Approval Listings |    |    |     |     |
|                        | DN | In. | DN | In.  |         |         |         |                        |                        |              | LPCB              | FM | UL | MEA | NSF |
| 80032                  | 25 | 1"  | 20 | 3/4" | 40      | 40      | 41      | 1                      | 17                     | 0.073        | ✓                 | ✓  | ✓  | ✓   | ✓   |